

TERAFLEX PRODUCT INSTALLATION GUIDE

JK Rock Slider Kit

Part #4637300

Part #4637310

Part #4937300

Part #4937310

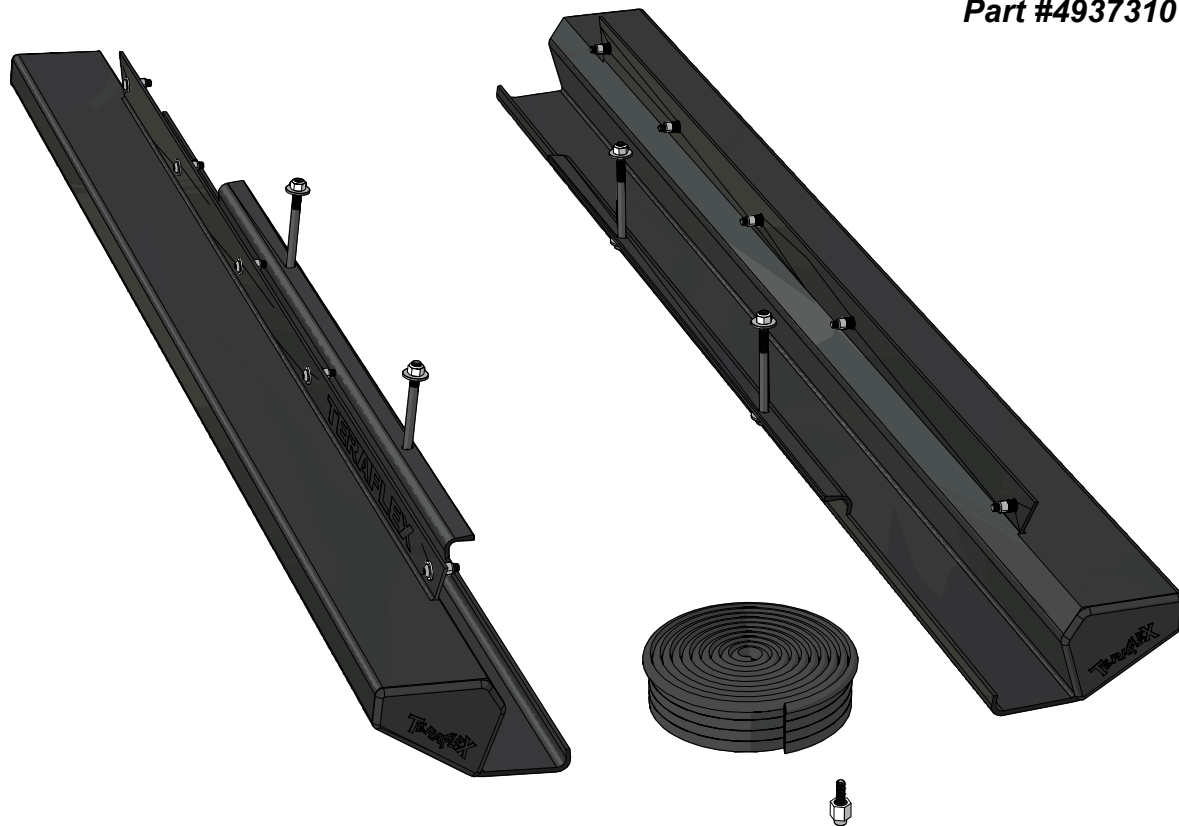

Important Notes:

Prior to beginning this or any installation read these instructions to familiarize yourself with the required steps and evaluate if you are experienced and capable to personally perform these modifications.

Refer to the parts list to ensure that all necessary components and hardware has been included. If any parts are missing please contact your local retailer for assistance.

Drilling through the body is required for the installation of these rock sliders. Use caution when drilling through both the sides and bottom of the Jeep to insure that you do not damage the wiring harness that runs along the bottom of the door frames or the carpet on the floor of the Jeep.

Tools needed:

- Jack
- Block of Wood
- 1/2" Wrench
- 9/16" End Wrench
- 3/16" Allen Wrench
- 5/32" Allen Wrench
- Drill
- 1/8" Drill Bit
- 25/64" Drill Bit
- Painter's Tape

Scan the QR code to watch the install video on YouTube!



TeraFlex, Inc.
5680 W Dannon Way
West Jordan, UT 84081
Phone/801.288.2585
Fax/801.713.2313
www.teraflex.com

999012
Revised: 20 Sept, 2013 DTB

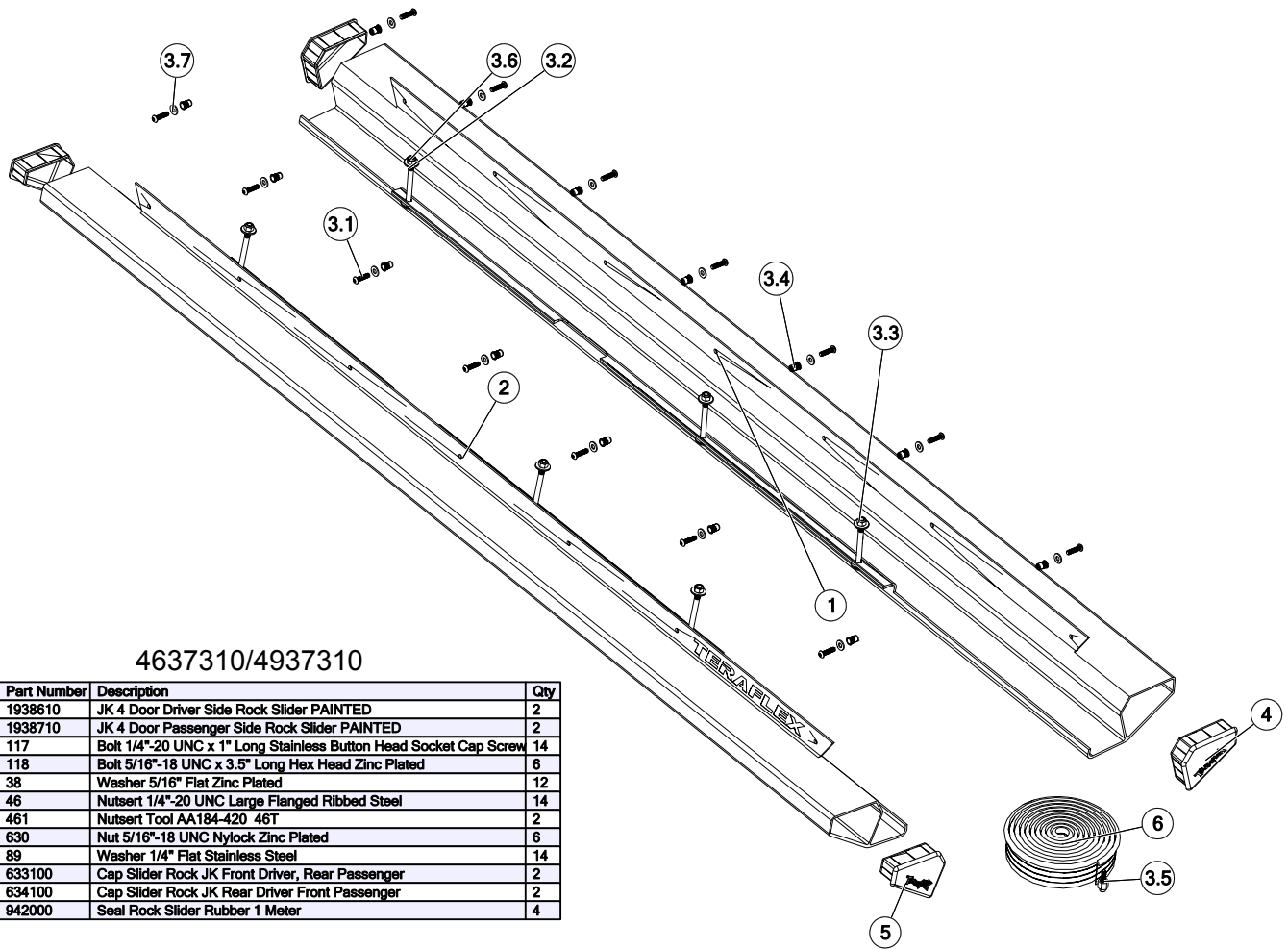

4637310/4937310

BOM ID	Part Number	Description	Qty
1	1938610	JK 4 Door Driver Side Rock Slider PAINTED	2
2	1938710	JK 4 Door Passenger Side Rock Slider PAINTED	2
3.1	117	Bolt 1/4"-20 UNC x 1" Long Stainless Button Head Socket Cap Screw	14
3.2	118	Bolt 5/16"-18 UNC x 3.5" Long Hex Head Zinc Plated	6
3.3	38	Washer 5/16" Flat Zinc Plated	12
3.4	46	Nutsert 1/4"-20 UNC Large Flanged Ribbed Steel	14
3.5	461	Nutsert Tool AA184-420 46T	2
3.6	630	Nut 5/16"-18 UNC Nylock Zinc Plated	6
3.7	89	Washer 1/4" Flat Stainless Steel	14
4	633100	Cap Slider Rock JK Front Driver, Rear Passenger	2
5	634100	Cap Slider Rock JK Rear Driver Front Passenger	2
6	942000	Seal Rock Slider Rubber 1 Meter	4

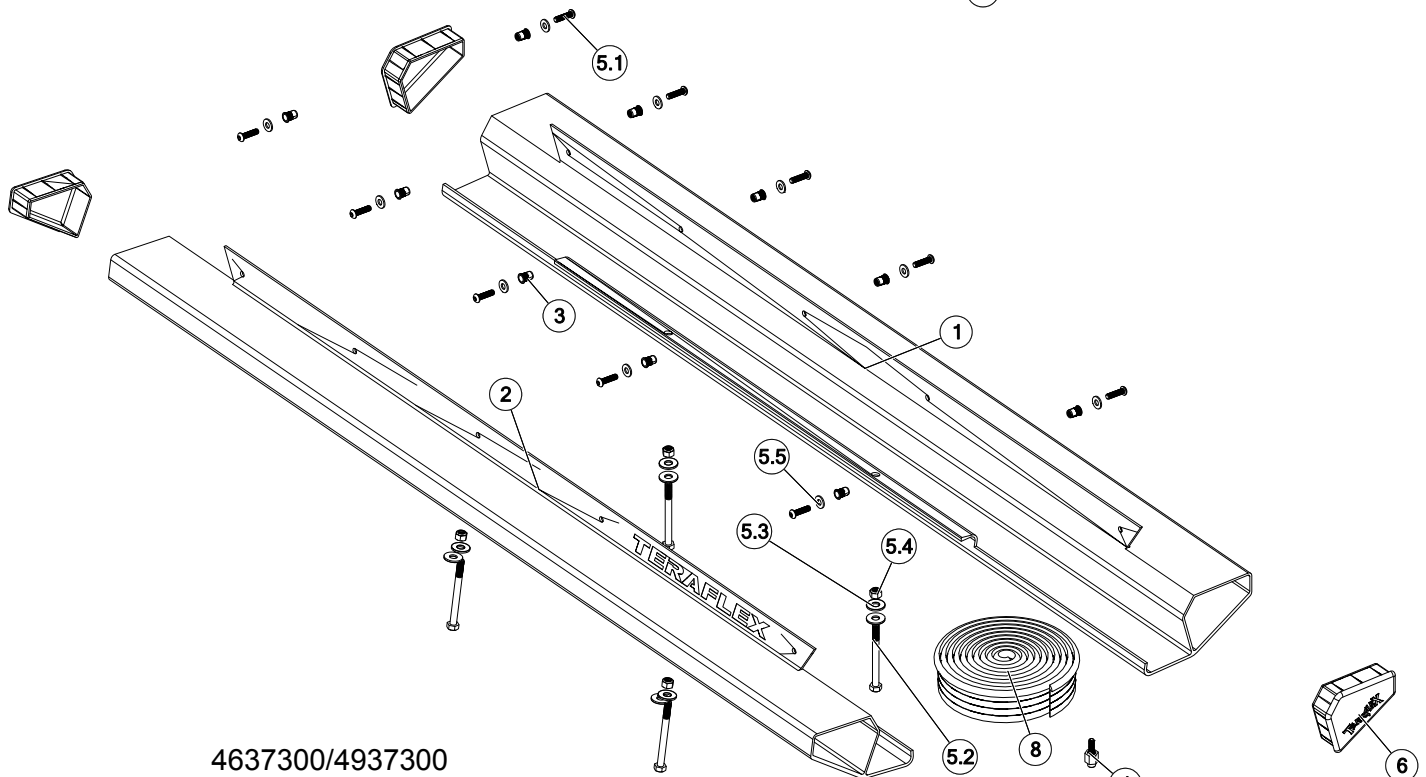

4637300/4937300

BOM ID	Part Number	Description	Qty
1	1938600	JK 2 Door Driver Side Rock Slider PAINTED	2
2	1938700	JK 2 Door Passenger Side Rock Slider PAINTED	2
3	46	Nutsert 1/4"-20 UNC Large Flanged Ribbed Steel	10
4	461	Nutsert Tool AA184-420 46T	2
5.1	117	Bolt 1/4"-20 UNC x 1" Long Stainless Button Head Socket Cap Screw	10
5.2	118	Bolt 5/16"-18 UNC x 3.5" Long Hex Head Zinc Plated	4
5.3	38	Washer 5/16" Flat Zinc Plated	8
5.4	630	Nut 5/16"-18 UNC Nylock Zinc Plated	4
5.5	89	Washer 1/4" Flat Stainless Steel	10
6	633100	Cap Slider Rock JK Front Driver, Rear Passenger	2
7	634100	Cap Slider Rock JK Rear Driver Front Passenger	2
8	942000	Seal Rock Slider Rubber 1 Meter	1

Installation:

1. Remove the factory steps (if equipped) from each side of the vehicle.
2. Put tape along the body under the door and on the fender flares to protect the paint from scratching during installation. (Figure 1)



Figure 1

3. Hold the new rock slider up in place. Make sure it is centered and fits up flush against the fender flares. Mark all holes on the tape using a marker. It is helpful to use a jack with a block of wood on top to hold the slider in place while marking holes. Use a center punch on all of the holes to help center the drill bit when drilling.



Figure 2

4. Drill a 25/64" hole at each mark to prepare for installation of the nut inserts. Paint the drilled holes to help prevent rust from forming.

Note: It is helpful to drill a pilot hole using a smaller drill bit. Use caution when drilling through the body to avoid damaging the wiring harness that runs along the bottom of the door frame.

5. Install the nut inserts along the body using the included insert tool. (Figure 3)



Figure 3

Note: Thread a bolt into each of the nut inserts. If any of them don't thread in smoothly, be sure to use a 1/4"-20 tap to clean the threads up.

6. Put the rubber seal along the top edge of the rock slider and cut to length. While holding the gasket in place on the back of the slider, mark the gasket where the bolt holes need to be drilled. Using the same 25/64" drill bit, drill holes in the gasket at all of the marks. Set the gasket aside. (Figure 4)



Figure 4

7. Hold the rock slider up to the side of the Jeep and start the front and rear bolt to hold the slider in place. Grab the gasket, and starting at the middle of the rock slider, slide the gasket in between the body and the slider. Line up the holes in the gasket and start all the bolts. Remove the front and rear bolts and slide the gasket in place. Tighten all the bolts. (Figure 5)



Figure 5

8. With the body side bolts installed, drill up through the bottom holes of the rock slider. Be sure to pull back the carpet before drilling. (Figure 6)



Figure 6

9. After drilling the holes, install and tighten the long through bolts and replace the carpet. (Figure 7)



Figure 7

Repeat steps 2 through 9 for the other side.



Installation is complete.



TERAFLEX **PRODUCT INFORMATION**

MAINTENANCE INFORMATION:

It is the buyer's responsibility to have all suspension, drivetrain, steering, and other components checked for proper tightness and torque after the first 100 miles and every 3000 miles after that.

NOTICE TO INSTALLER:

The enclosed "Warning to Driver" sticker must be installed in the vehicle in driver's view. This sticker is to act as a constant safety reminder when operating the vehicle. It is your responsibility as the equipment installer to install the provided sticker and to forward the product instructions to the vehicle's owner for review. If a "Warning to Driver" sticker or product installation guide were not included in the kit, FREE replacement stickers and instructions are available by request. It is the installer's duty to ensure a safe and controllable vehicle after the modifications have been performed.

WARNING:

Neither the seller nor the manufacturer will be liable for any loss, damage, or injury directly or indirectly arising from the use of or inability to determine the use of these products. Before using, the user shall determine the suitability of the products for its intended use, and the user shall assume all responsibility and risk in connection therewith.

WARNING TO DRIVER:

This vehicle has been modified to enhance off road performance and has unique handling characteristics. Use in harsh environments can cause extreme stress on the components. Vehicle should be inspected after being off road to make sure that all the components are in working order and safe to travel on the highway. All fasteners should be checked so that they are at the correct torque specifications as the vibration and stresses from off-roading may cause critical fasteners to work loose. Extra care should be taken to inspect the critical components, steering, and brake systems. During each oil change components such as arms, tie rod ends, etc. should be greased and checked for excessive wear. Any worn components should be replaced. When returning to the pavement always set or restore tire air pressure to the factory recommendation and connect or engage any disabled sway bar mechanisms. Because of the higher center of gravity and larger tires, this vehicle handles and reacts differently than many passenger cars, both on and off road. You must drive it safely! Extreme care should be taken to prevent vehicle rollover or loss of control, which can result in serious injury or death. Avoid sudden sharp turns or abrupt maneuvers. Generally, braking performance and capabilities are decreased when significantly larger/heavier tires are used, especially when used in combination with transfer case low-range reduction kits. Take this into consideration while driving. Do not add, alter or fabricate any factory or aftermarket parts to increase vehicle height over the intended height of the TeraFlex product purchased. Mixing component brand is not recommended. TeraFlex Inc. will not be responsible for any altered product or any improper installation or use of our products. We will be happy to answer any questions concerning the design, function, and correct use of our products. It is ultimately the buyer's responsibility to have all bolts/nuts checked for tightness after the first 100 miles and then every 3000 miles. Wheel alignment, steering system, suspension and drive line systems must be inspected by a qualified professional mechanic at least every 3000 miles.

TERAFLEX PRODUCT WARRANTY:

Tera Manufacturing warrants TeraFlex Suspension products to the original retail purchaser to be free of defects in material and workmanship for as long as the original purchaser owns the vehicle on which products were originally installed. Failure to complete regular maintenance (grease every 3000 miles) on TeraFlex FlexArms will void this warranty. All other conditions of the standard TeraFlex product warranty apply.

All TeraLow products are covered by TeraFlex's two (2) year warranty to be free of defects in material and workmanship for two years from date purchased.

Tera axles are covered by a 12-month warranty to be free of defects in materials and workmanship. This warranty does not cover or include product finish, improperly installed or applied products, improperly maintained products, products or components used for racing or competition or damage due to abuse or neglect, products that fail due to the use of larger tire and wheel combinations.

All returns must be accompanied by an original invoice. It is the customer's responsibility to remove the product from the vehicle. Shipping charges are the responsibility of the customer. Tera Manufacturing will pay the return freight if the product meets the terms of warranty.

This warranty is for the replacement or repair of defective TeraFlex products only and does not include freight charges, labor charges for removal of or installation of TeraFlex or related products or components, costs incurred due to down time of the vehicle, or lost profits due to vehicle down time.

A returned goods authorization number (RGA#) must accompany any returned products. For more information please contact a TeraFlex customer service representative.

COPYRIGHT

©Copyright 2008. All rights reserved, TeraFlex Inc. Reproduction of this catalog and/or any of its contents without written permission is strictly prohibited.

TeraFlex® is a registered trademark of TeraFlex Inc. All trade names and logos including but not limited to TeraFlex, FlexArms, RockGuard, Monster, and LCG are protected by law and duplication of trade names and/or logos are strictly prohibited.

TeraFlex Inc. reserves the right to update, discontinue, redesign, modify finish, part number or component build parts if deemed necessary without written notice. TeraFlex Inc., and any associated dealers are not responsible for misprints or typographical errors that may have inadvertently been made within this instruction sheet.

Jeep® and the Jeep® grill are registered trademarks of Chrysler LLC, and have no affiliation with TeraFlex Inc.